

FCC Statement

This equipment has been tested and found to comply with the limits for a Class A digital device, pursuant to part 15 of the FCC Rules. These limits are designed to provide reasonable protection against harmful interference when the equipment is operated in a commercial environment. This equipment generates, uses, and can radiate radio frequency energy and, if not installed and used in accordance with the instruction manual, may cause harmful interference to radio communications. Operation of this equipment in a residential area is likely to cause harmful interference in which case the user will be required to correct the interference at his own expense.

This device complies with Part 15 of FCC Rules.

Operation is subject to the following two conditions:

- (1) This device may not cause harmful interference, and
- (2) This device must accept any interference received, including interference that may cause undesired operation.



NOTE:

THE MANUFACTURER IS NOT RESPONSIBLE FOR ANY RADIO OR TV INTERFERENCE CAUSED BY UNAUTHORIZED MODIFICATIONS TO THIS EQUIPMENT. SUCH MODIFICATIONS COULD VOID THE USER'S AUTHORITY TO OPERATE THIS EQUIPMENT.



REMARQUE :

LE FABRICANT N'EST PAS RESPONSABLE DES INTERFÉRENCES RADIO OU TÉLÉ CAUSÉES PAR DES MODIFICATIONS NON AUTORISÉES DE CET ÉQUIPEMENT. DE TELLES MODIFICATIONS POURRAIENT ANNULER L'AUTORISATION DE L'UTILISATEUR À FAIRE FONCTIONNER CET ÉQUIPEMENT.

Electromagnetic Interference and Compatibility



CAUTION: ELECTROMAGNETIC INTERFERENCE

NEARLY EVERY ELECTRONIC DEVICE IS SUSCEPTIBLE TO ELECTROMAGNETIC INTERFERENCE (EMI) IF INADEQUATELY SHIELDED, DESIGNED, OR OTHERWISE CONFIGURED FOR ELECTROMAGNETIC COMPATIBILITY.



MISE EN GARDE : INTERFÉRENCE ÉLECTROMAGNÉTIQUE

PRESQUE TOUS LES APPAREILS ÉLECTRONIQUES SONT SENSIBLES AUX INTERFÉRENCES ÉLECTROMAGNÉTIQUES (EMI) S'ILS NE SONT PAS CORRECTEMENT PROTÉGÉS, CONÇUS OU CONFIGURÉS POUR LA COMPATIBILITÉ ÉLECTROMAGNÉTIQUE.

Facilities

To avoid electromagnetic interference and/or compatibility conflicts, turn off your smartphone in any area where posted notices instruct you to do so. Hospitals or health care facilities may be using equipment in certain areas that is sensitive to external RF energy.

Installations

Pour éviter les interférences électromagnétiques ou les conflits de compatibilité, éteindre votre téléphone intelligent dans tous les endroits où des avis affichés vous demandent de le faire. Les hôpitaux ou les établissements de soins de santé peuvent utiliser, dans certaines zones, des équipements sensibles à l'énergie RF externe.

Potentially Explosive Atmospheres

Do not take your smartphone, Charger, or battery into any area with a potentially explosive atmosphere. Do not remove, install, or charge batteries in such areas. Sparks in a potentially explosive atmosphere can cause an explosion or fire resulting in bodily injury or even death.

Atmosphères potentiellement explosives

Ne pas emporter votre téléphone intelligent, votre chargeur ou votre batterie dans une zone où l'atmosphère est potentiellement explosive. Ne pas retirer, installer ou charger les batteries dans ces zones. Les étincelles dans une atmosphère potentiellement explosive peuvent provoquer une explosion ou un incendie entraînant des blessures corporelles ou même la mort.



WARNING: POTENTIALLY EXPLOSIVE ATMOSPHERES

AREAS WITH POTENTIALLY EXPLOSIVE ATMOSPHERES INCLUDE FUELING AREAS SUCH AS BELOW DECKS ON BOATS, FUEL OR CHEMICAL TRANSFER OR STORAGE FACILITIES, AREAS WHERE THE AIR CONTAINS CHEMICALS OR PARTICLES SUCH AS GRAIN, DUST, OR METAL POWDERS, AND ANY OTHER AREA WHERE YOU WOULD NORMALLY BE ADVISED TO TURN OFF YOUR VEHICLE ENGINE. AREAS WITH POTENTIALLY EXPLOSIVE ATMOSPHERES ARE OFTEN POSTED, BUT NOT ALWAYS.



AVERTISSEMENT : ATMOSPHÈRES POTENTIELLEMENT EXPLOSIVES

LES ZONES À ATMOSPHÈRE POTENTIELLEMENT EXPLOSIVE COMPRENNENT LES ZONES DE RAVITAILLEMENT EN CARBURANT COMME LES PONTS INFÉRIEURS DES BATEAUX, LES INSTALLATIONS DE TRANSFERT OU DE STOCKAGE DE CARBURANT OU DE PRODUITS CHIMIQUES, LES ZONES OÙ L'AIR CONTIENT DES PRODUITS CHIMIQUES OU DES PARTICULES TELLES QUE DES GRAINS, DE LA POUSSIÈRE OU DES POUDRES MÉTALLIQUES, ET TOUTE AUTRE ZONE OÙ IL VOUS SERAIT NORMALEMENT CONSEILLÉ DE COUPER LE MOTEUR DE VOTRE VÉHICULE. LES ZONES À ATMOSPHÈRE POTENTIELLEMENT EXPLOSIVE SONT SOUVENT SIGNALÉES, MAIS PAS DANS TOUS LES CAS.

Important Warnings



WARNING: DO NOT...

DO NOT PUNCTURE, IMMERSE THE BATTERY PACK IN WATER OR THROW IT INTO FIRE.



WARNING: DO NOT...

DO NOT DISPOSE OF THE BATTERY PACK WITH YOUR DOMESTIC WASTE. TAKE USED BATTERY PACKS TO AN APPROPRIATE COLLECTION POINT FOR RECYCLING OR SEND THEM BACK TO YOUR SUPPLIER OR SERVICING AGENT.



WARNING: DO NOT...

ALL BATTERIES CAN CAUSE PROPERTY DAMAGE AND/OR BODILY INJURY, SUCH AS BURNS, IF A CONDUCTIVE MATERIAL SUCH AS JEWELRY, KEYS, OR BEADED CHAINS TOUCHES EXPOSED TERMINALS. THE CONDUCTIVE MATERIAL MAY COMPLETE AN ELECTRICAL CIRCUIT (SHORT CIRCUIT) AND BECOME QUITE HOT. EXERCISE CARE IN HANDLING ANY CHARGED BATTERY, PARTICULARLY WHEN PLACING IT INSIDE A POCKET, PURSE, OR OTHER CONTAINER WITH METAL OBJECTS.



WARNING: DO NOT...

WARNING: THE BATTERY USED IN THIS DEVICE MAY PRESENT A RISK OF FIRE OR CHEMICAL BURN IF MISTREATED. DO NOT DISASSEMBLE, HEAT ABOVE 45°C, OR INCINERATE. USE THIS CHARGER TO CHARGE SPECTRALINK BATTERY PACK MODEL BLI9200100 ONLY. CHARGING ANOTHER MODEL BATTERY PRESENTS A RISK OF FIRE OR EXPLOSION.



WARNING: EXPLOSION RISK

WARNING: THERE IS A RISK OF EXPLOSION IF YOU REPLACE THE BATTERY PACK WITH AN INCORRECT TYPE. ONLY USE SPECTRALINK MODEL BLI9200100 BATTERY PACKS WITH SPECTRALINK VERSITY SMARTPHONES. DISPOSE OF USED BATTERIES ACCORDING TO THE INSTRUCTIONS.

Avertissements importants



AVERTISSEMENT : NE PAS...

NE PAS PERCER, IMMERGER LA BATTERIE DANS L'EAU NI LA JETER AU FEU.



AVERTISSEMENT : NE PAS...

NE PAS JETER LA BATTERIE AVEC VOS DÉCHETS DOMESTIQUES. AMENER LES BATTERIES USAGÉES À UN POINT DE COLLECTE APPROPRIÉ POUR LEUR RECYCLAGE OU LES RETOURNER À VOTRE FOURNISSEUR OU À VOTRE AGENT DE SERVICE.



AVERTISSEMENT : NE PAS...

TOUTES LES BATTERIES PEUVENT CAUSER DES DOMMAGES MATÉRIELS OU CORPORELS, COMME DES BRÛLURES, SI UN MATÉRIAU CONDUCTEUR TEL QUE DES BIJOUX, DES CLÉS OU DES CHÂÎNES TOUCHE LES BORNES EXPOSÉES. LE MATÉRIAU CONDUCTEUR PEUT CRÉER UN CIRCUIT ÉLECTRIQUE (COURT-CIRCUIT) ET DEVENIR CHAUD. FAIRE PREUVE DE PRUDENCE DANS LA MANIPULATION DE TOUTE BATTERIE CHARGÉE, EN PARTICULIER LORSQU'ELLE EST PLACÉE DANS UNE POCHE, UN SAC À MAIN OU TOUT AUTRE RÉCIPENT CONTENANT DES OBJETS MÉTALLIQUES.



AVERTISSEMENT : NE PAS...

AVERTISSEMENT : LA BATTERIE UTILISÉE DANS CET APPAREIL PEUT PRÉSENTER UN RISQUE D'INCENDIE OU DE BRÛLURE CHIMIQUE EN CAS DE MANIPULATION. NE PAS DÉMONTER, CHAUFFER À PLUS DE 45 °C OU INCINÉRER. N'UTILISER CE CHARGEUR QUE POUR CHARGER LE BLOC-PILES SPECTRALINK MODÈLE BLI9200100. LA CHARGE D'UN AUTRE MODÈLE DE BATTERIE PRÉSENTE UN RISQUE D'INCENDIE OU D'EXPLOSION.



AVERTISSEMENT : NE PAS...

AVERTISSEMENT : IL Y A RISQUE D'EXPLOSION SI VOUS REMPLACEZ LA BATTERIE PAR UN MODÈLE NON APPROPRIÉ. UTILISER UNIQUEMENT LES BATTERIES SPECTRALINK MODÈLE BLI9200100 AVEC LES TÉLÉPHONES INTELLIGENTS SPECTRALINK VERSITY. JETER LES PILES USAGÉES CONFORMÉMENT AUX INSTRUCTIONS.

Any changes or modifications not expressly approved by the party responsible for compliance could void the user's authority to operate the equipment.

Tout changement ou toute modification non expressément approuvé par la partie responsable de la conformité pourrait annuler le droit de l'utilisateur à utiliser l'équipement.



NOTE:

SEE LABEL ON THE BOTTOM OF THE DEVICE FOR ADDITIONAL REGULATORY INFORMATION.



REMARQUE :

VOIR L'ÉTIQUETTE SUR LE DESSOUS L'APPAREIL POUR DES INFORMATIONS RÉGLEMENTAIRES SUPPLÉMENTAIRES.

the express written consent of Spectralink Corporation. means, or translated into another language or format, in whole or part, without any Product Identification, copyright or other notices. No part of the contents of this document may be copied, reproduced, or transmitted in any form or by any means, or translated into another language or format, in whole or part, without the express written consent of Spectralink Corporation.

Copyright Notice

© 2020-2021 Spectralink Corporation. All rights reserved under International and pan-American Copyright Conventions. Spectralink™, the Spectralink logo and the names and marks associated with Spectralink's products are trademarks and/or service marks of Spectralink Corporation and are common law marks in the United States and various other countries. All other trademarks are property of their respective owners. Do not remove (or allow any third party to remove) any Product Identification, copyright or other notices. No part of the contents of this document may be copied, reproduced, or transmitted in any form or by any means, or translated into another language or format, in whole or part, without the express written consent of Spectralink Corporation.

Spectralink Corporation

US Location +1 800-775-5330

Denmark Location +45 7560 2850

Spectralink Corporation Spectralink Europe Aps

329 Bracknell, Doncastle Road Bognor Regis, West Sussex, PO19 1UD, UK

2560 55th Street Boulder, CO 80301

8700 Horsens Bymøllevej, Søpark 21 E Stuen Bracknell, Berkshire, RG12 8PE, UK

info@spectralink.com

info@spectralink.com

info@spectralink.com

info@spectralink.com

info@spectralink.com

info@spectralink.com

info@spectralink.com

info@spectralink.com

info@spectralink.com

info@spectralink.com

info@spectralink.com

info@spectralink.com

info@spectralink.com

info@spectralink.com

info@spectralink.com

info@spectralink.com

info@spectralink.com

info@spectralink.com

info@spectralink.com

info@spectralink.com

Contact Information

spectralink

Spectralink Versity 92 Series Chargers



Introduction to Desktop Chargers

Spectralink offers two desktop models for charging the Versity 92 Series smartphones.

Versity 92 Series Desktop Dual Charger
ACH9200101

Versity 92 Series Desktop Phone Charger
ACH9200100

Versity 92 Series Smartphone Models

Use only 92 Series products with other 92 Series products as identified by the model number located on the label of the product.

Manufacturer: Spectralink MODEL: VC9253

Manufacturer: Spectralink MODEL: VC9240

Versity 92 Series LI Battery Model

Use only 92 Series products with other 92 Series products as identified by the model number located on the label of the product.

Versity 92 Series LI Battery MODEL: BLI9200100

Versity 92 Series Desktop Chargers Power Supply

Both Desktop Charger models use the same power supply.

Manufacturer: Shenzhen Simsukian Electronics
Technology Co, LTD

Models: Power Supply Variants

Area	Spectralink Part Number	Model
Australia New Zealand	APS9200700	SK01T8-0570260S
Europe	APS9200500	SK01T8-0570260V
UK	APS9200300	SK01T8-0570260B
US	APS9200000	SK01T8-0570260U

Introduction to Multi Chargers

Spectralink offers two Multi Charger models for charging the Versity 92 Series smartphones. The Multi Chargers hold either six 92 Series batteries or six 92 Series smartphones.

Versity 92 Series Smartphone Models

Use only 92 Series products with other 92 Series products as identified by the model number located on the label of the product.

Manufacturer: Spectralink MODEL: VC9253

Manufacturer: Spectralink MODEL: VC9240

Versity 92 Series LI Battery Model

Use only 92 Series products with other 92 Series products as identified by the model number located on the label of the product.

Versity 92 Series LI Battery MODEL: BLI9200100

Versity 92 Series Multi Chargers Power Supply

The correct power supply is shipped with the Multi Charger as appropriate for the region of use per the table below.

Manufacturer: Shen Zhen Kuanten Limited

Model: KT090A1200667B3

Region	Spectralink Part Number	Model
NA	ACH9200002	Multi Battery Charger
NA	ACH9200003	Multi Smartphone Charger
EU	ACH9200502	Multi Battery Charger
EU	ACH9200503	Multi Smartphone Charger
UK	ACH9200302	Multi Battery Charger
UK	ACH9200303	Multi Smartphone Charger
AU	ACH9200702	Multi Battery Charger
AU	ACH9200703	Multi Smartphone Charger

Chargers and Battery Packs

All Spectralink Versity 92 Series Chargers are designed to charge Spectralink Versity 92 Series Battery Packs. This Battery Pack contains a lithium ion battery that is subject to certain usage characteristics as detailed below. Be sure to follow battery handling guidelines to ensure safe use and a long battery life.

- Optimal battery charging results with ambient temperatures between 50°F to 86°F (10°C to 30°C). Operating outside of this temperature may result in extended charge times or incomplete charge cycle.
- Ensure that charging equipment environments are ventilated and temperature controlled for best performance.
- Do not place anything in the charging bay other than a single Battery or smartphone as appropriate to avoid bending the contacts. Bent contacts can keep the Battery Pack from charging.
- Only use genuine Spectralink Versity 92 Series Battery Packs with Spectralink Versity 92 Series Chargers.
- Never use a non-genuine charging unit as it could damage the Battery Pack.
- Use only the original plug-in power supply provided by Spectralink for the Chargers.
- Contact your service representative for assistance if you have a faulty Battery Pack or a problem with your Charger.
- Any battery that exhibits swelling, cracking or other abnormality should be disposed of promptly and properly.

La charge des batteries est optimale lorsque la température ambiante se situe entre 10 °C et 30 °C (50 °F et 86 °F). Le fonctionnement hors de cette température peut entraîner des temps de charge prolongés ou un cycle de charge incomplet.

- Veillez à ce que les environnements des équipements de recharge soient ventilés et à ce que la température soit contrôlée pour obtenir les meilleures performances.
- Ne placer rien d'autre qu'une seule batterie dans la station de charge pour éviter de déformer les contacts. Des contacts déformés peuvent empêcher la batterie de se recharger.
- N'utiliser que des batteries Spectralink Versity 92 Series authentiques avec les chargeurs Spectralink Versity 92 Series.
- Ne jamais utiliser un chargeur qui n'est pas authentique, car il pourrait endommager la batterie.
- Utiliser uniquement le bloc d'alimentation d'origine fourni par Spectralink pour les chargeurs.
- Contactez votre représentant de service pour obtenir de l'aide si vous avez une batterie défectueuse ou un problème avec votre chargeur.
- Toute batterie qui présente un gonflement, une fissure ou toute autre anomalie doit être éliminée rapidement et correctement.

LED Behavior

The LED beside the charging slot indicates the charging status of the Battery Pack. The following table lists the LED indications and Battery Pack status.

Under normal conditions, a discharged battery pack will fully charge in approximately 3.5 hours.

For the Versity 92 Series Dual Charger, battery pack charge time may be extended due to priority charging of the phone when both phone and battery pack are inserted.

LED Indication	Battery Pack Status
Solid red	Charging
Solid green	Fully charged
Off	Indicates an empty slot or an error condition
Blinking	Blinks at charger power up

Using the Versity 92 Series Multi Chargers

Two Multi Chargers are available, a Multi Battery Charger for batteries only and a Multi Smartphone Charger for the smartphone with a battery installed.

Plug the power supply into the rear of the charger. The RED and GREEN LEDs on the charger will blink at powerup.

Phones or batteries are simply placed in the slot so that the contacts align. When the contacts are properly aligned, the LED will indicate the charging state.

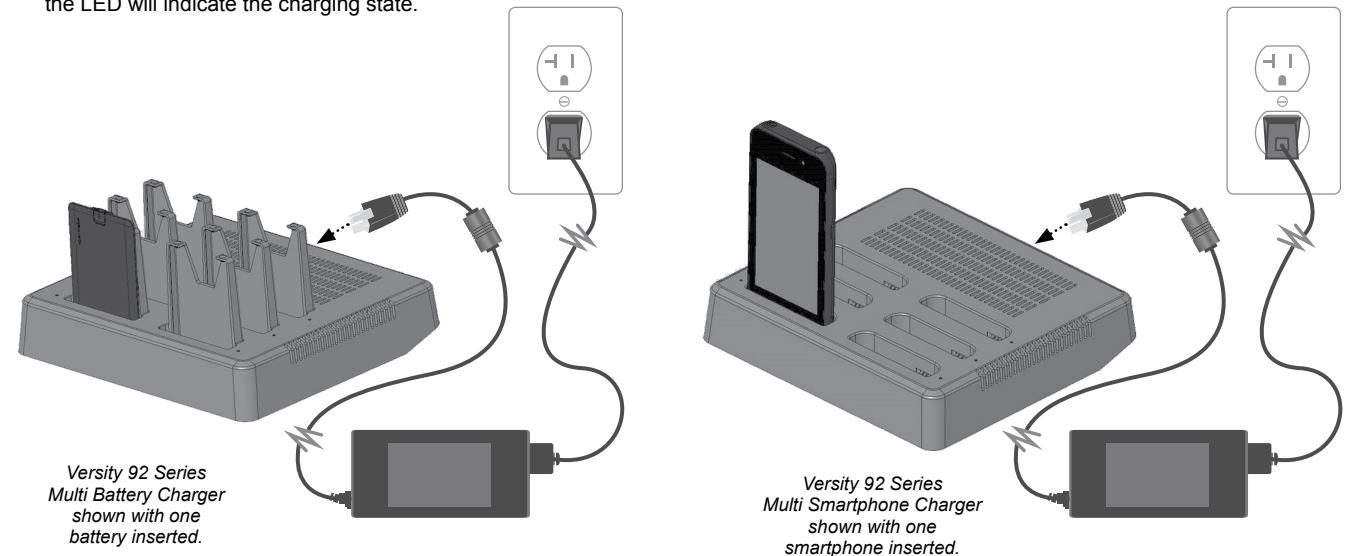

Using the Versity 92 Series Desktop Chargers

Two chargers are available for charging batteries — the Versity 92 Series Desktop Dual Charger and the Versity 92-Series Desktop Phone Charger.

Versity 92 Series Desktop Dual Charger

- Place the module on a flat surface within reach of power. Ensure the power supply has the correct plug for your area. (Power supplies are designed with fixed regional plug, make sure the plug is suitable for your region US/EU/UK/AU.)
- Plug in the barrel connector of the power supply into the charger base. The phone takes priority when both slots are in use and charging.
- Plug the other end into a wall outlet. The RED and GREEN LEDs on the charger will blink at powerup.

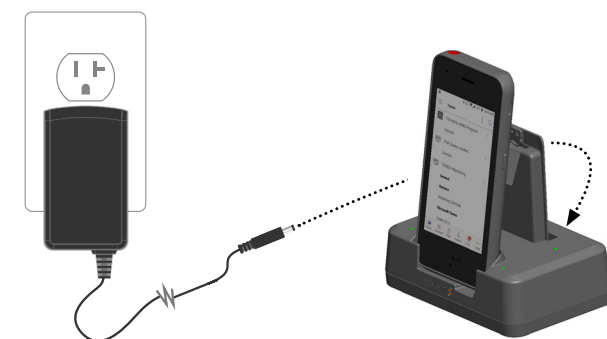

Versity 92 Series Desktop Phone Charger

- Set up the Versity 92 Series Desktop Phone Charger as described at left for the Dual Charger. The RED and GREEN LEDs on the charger will blink at powerup.
- Place Versity 92 Series smartphone (with battery inserted) face forward into the Phone Charger slot. When properly seated, the LEDs will turn on.

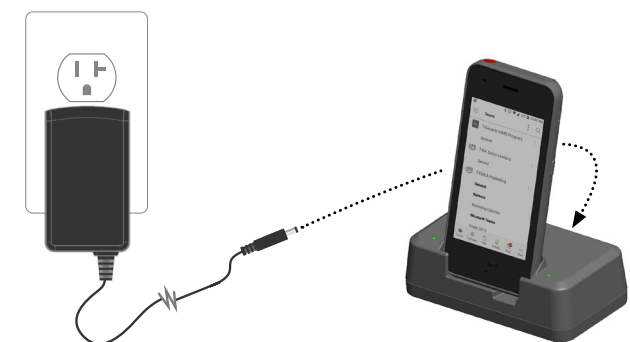

CAUTION: CHARGING VERSITY 92 SERIES IN THE DESKTOP CHARGERS

USE ONLY THE SPECTRALINK-SUPPLIED POWER SUPPLY WITH THE VERSITY 92 SERIES DESKTOP DUAL CHARGER AND VERSITY 92 SERIES DESKTOP BATTERY CHARGER.

ATTENTION : CAPACITÉ DE CHARGE DES VERSITY 92 SERIES CHARGEURS DE BUREAU

UTILISEZ UNIQUEMENT LE BLOC D'ALIMENTATION FOURNI PAR SPECTRALINK POUR LE CHARGEUR DOUBLE DE BUREAU VERSITY 92 SERIES ET LE CHARGEUR DE BATTERIE DE BUREAU VERSITY 92 SERIES.

- Place Versity 92 Series smartphone face forward into the Dual Charger front slot.

Place a spare Battery Pack in the rear slot so that the contacts align.

When properly seated, LEDs for both phone and battery pack will turn on.